

**1 SHOPFRONT SILL DETAIL**  
1 : 10

11

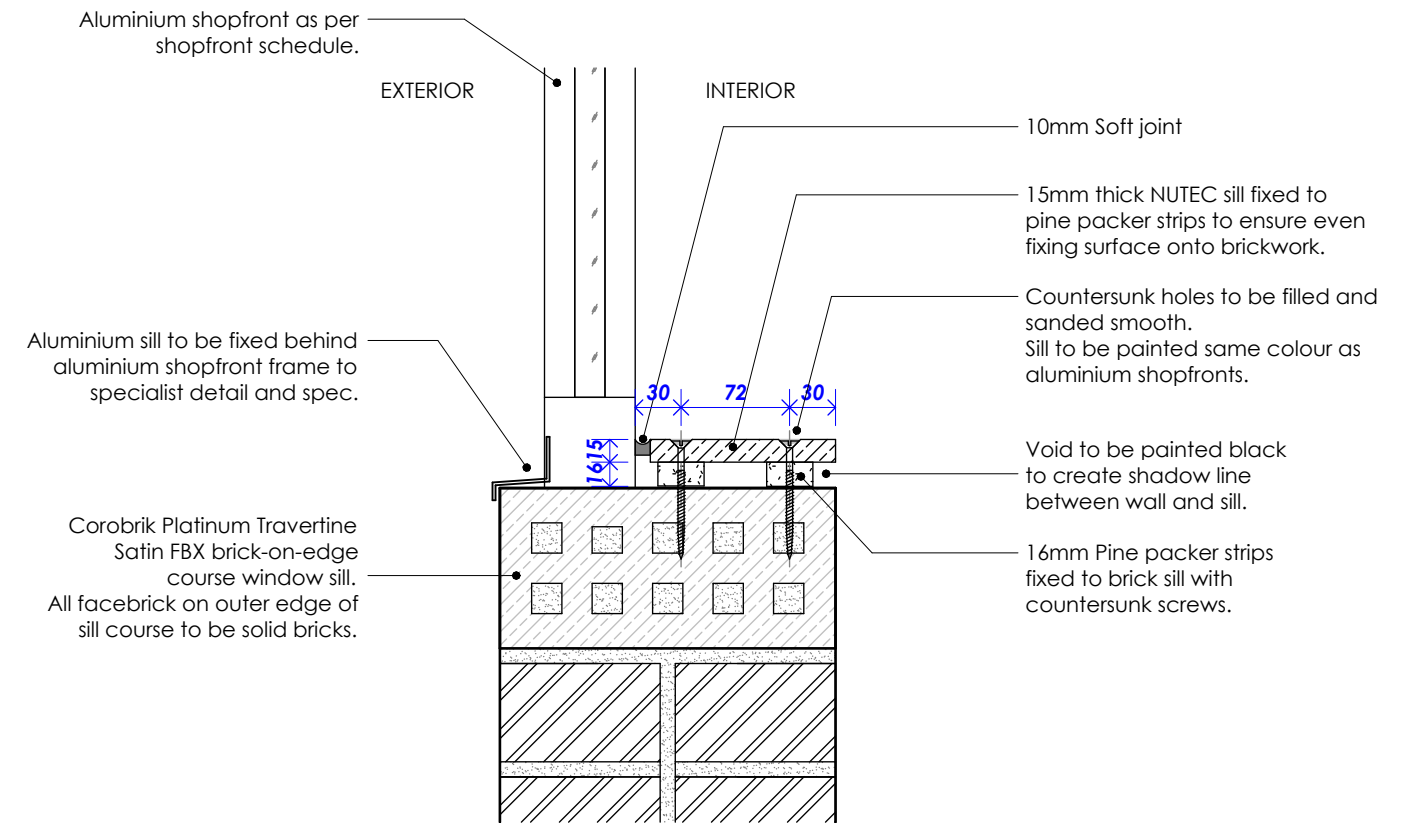
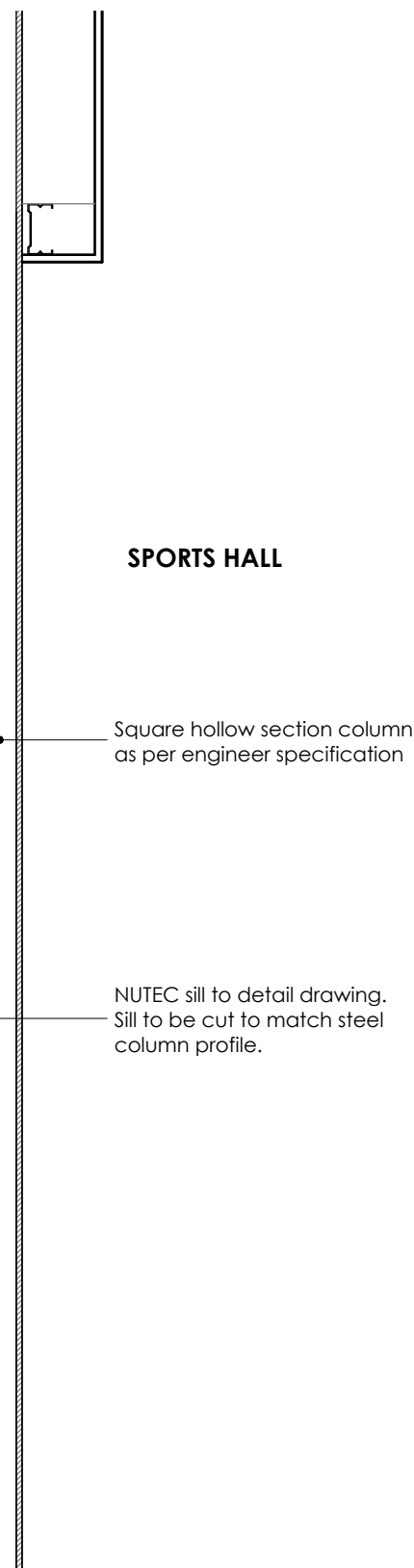

**2 Typical Shopfront Indoor Sill detail**  
1 : 5

project	rev	date	by	description
Sports Palace Courts Upgrade	1	12.02.2024	KP	Detail sheets renamed
drawing	scale	date	drawn	rev
SLIDING DOOR THRESHOLD DETAIL	As indicated @ A1	12.02.2024	KP	1
drawing no.	status	checked		
SPCU-AR - CN-8013	For Construction	JS		

johannesburg 97 second avenue melville 2092 | po box 31133 braamfontein 2017 | +27 11 482 1648 | office@jhb.gapp.net  
 cape town 150 longmarket st cape town 8001 | po box 15998 vlaeberg 8018 | +27 21 424 2390 | office@ctn.gapp.net  
 GAPP architects & urban designers (pty) ltd | reg no. 1993/003667/07 | www.gapp.net

